

MB-3XX accessories

French flags

In some extreme situations this flag is necessary to prevent lens flare. We have the following available:

French flag standard (31cm wide). Item **#0330-0001**

French flag wide (42cm wide). Item **#0330-0002**

Foldable wide French flag (48cm wide). Item **#0330-0003**



Side flag kits

For best protection against lens flare we recommend using a side flag kit.

MB-315/325 side flag kit Item **#0340-0001**, which consists of an extra large top flag, two side flags and two friction hinges.

MB-350 side flag kit Item **#0340-0002**, which consists of two side flags and two friction hinges.

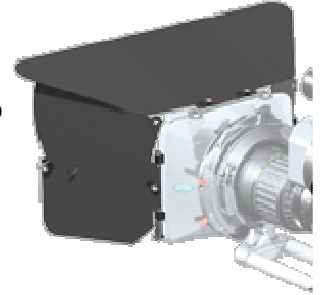

Filter frames

Filter frame 3"x3". Item **#0310-0008**

Filter frame 4"x4". Item **#0310-0001**

Filter frame 4,5"x4,5" Item **#0310-0002**

Filter frame 4"x6". Item **#0310-0003**

Filter frame 4"x5,65" (Panavision size). Item **#0310-0004**

Filter frame 4,5"x6" Item **#0310-0005**

Filter frame 4"x5" Item **#0310-0007**

4,5"x4,5" Polarizer filter Item **#0380-0001**

Filter slot size reducer Items **#0310-0009**, These inserts allow 109mm wide filter frames from other brands to be used in the rotatable filter slots of the MB-325 and the MB-350.

Note: 2pc. of 4"x4" filter frame are included in the standard mattebox kits.

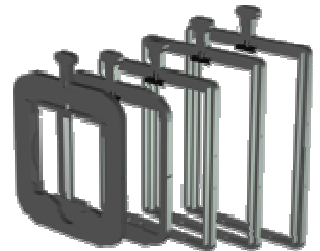

Step-down adapter rings

If a Broadcast mattebox is used as a clip-on (directly attached to the lens front), one of these following step down rings have to be used.

M37 Item **#0250-0125**

M58 Item **#0250-0130**

M72 Item **#0250-0140**

M82 Item **#0250-0143**

80mm Item **#0250-0120**

85mm Item **#0320-0001**

86mm Item **#0320-0002**

92mm Item **#0320-0030**

93mm Item **#0250-0141**

95mm Item **#0320-0003**

95mm. (Canon 11x4,5 only) Item **#0320-0008**

95mm. (Fujinon 10x4,8 / 13x4,5 only) Item **#0320-0021**

97mm Item **#0250-0142**

98mm Item **#0320-0004**

100mm Item **#0320-0020**



Care should be taken when using a clip-on mattebox to avoid damage to your equipment. We do not recommend the use of a clip-on mattebox in conjunction with a wide angle converter. Vocas is not responsible for any damage caused to your equipment through the use of a clip-on mattebox.

Flexible adapter ring kit

(54-95mm) Item **#0320-0009**

This kit contains several exchangeable flexible soft rubber rings. These rings do not allow the mattebox to be used as clip-on. The Mattebox has to be supported by a Mattebox support.



MBS-100, 15mm lightweight support

For superior camera protection, optimal compatibility with Arri and other accessories such as a follow focus.

Type "A" Item **#0350-0001**. Required for most broadcast cameras.

Type "B" Item **#0350-0003**. Required for JVC GYDV500.

Type "E" Item **#0350-0002**. Required for Philips.

These supports come with 2 pair of 15mm. rails. (170mm and 215mm)

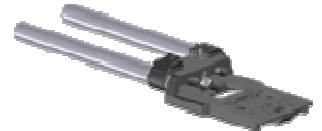

For further detailed information about which type of support you need for your specific camera, please see our website: www.vocas.com

15 mm barsadapter

Item **#0360-0001**

Adapter with quick-lock mechanism. (MB-300 Only after serial #C7228).

If a Vocas MB-3 serie mattebox is used on a standard 15mm lightweight support (or 15mm rails), this adapter is always needed.

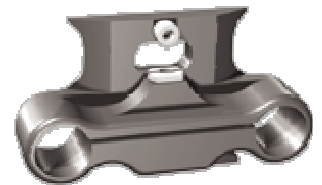

Z-shaped bar kit

Item **#0350-0020**

When a MBS-100 mattebox support is used, on some lenses the zoom remote connector becomes impossible to reach. For these lenses this kit is needed.

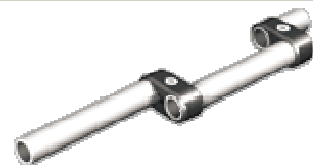

Mask kit

Set of 8 pieces mask 4:3 and 16:9 Item **#0250-0040**

These masks have the exact same outside dimension as a standard Panavision filter (4"x5,65"). In combination of a 4"x5,65" filter frame these masks can also be used in every other mattebox. In the MB-350 these masks can be placed directly in the hood of the mattebox, without the need for an additional filter frame.

